

# FrelTec

Mathildenstr. 10A  
82319 Starnberg  
Germany

## Surface Mount Schottky Rectifier SOD-123FL

SOD-123FL

Surface Mount Schottky Rectifier

SPECIFICATION

62B	FS_____xxxx	S13F	E03
Type	Type	Package	Packing
62B: Surface Mount Schottky Rectifier	FS_____	SOD-123FL	E03: tape in Embossed tape and reel for 3000 pc (7'REEL)

All products according to RoHS (2015/863/EU)



# SOD-123FL

# FrelTec Surface Mount Schottky Rectifier

## PACKAGE OUTLINE

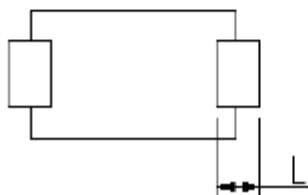
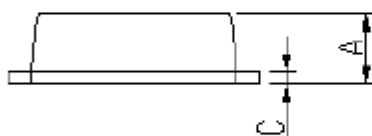
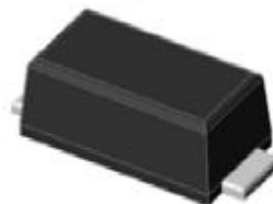
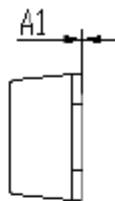
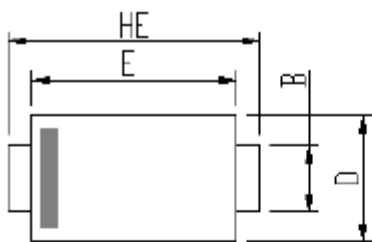

SOD-123FL  
eSGA

	Min	Max
A	0,9	1,08
A1	0	0,1
B	0,85	1,05
C	0,1	0,25
D	1,7	2
E	2,9	3,1
L	0,43	0,83
HE	3,5	3,9

SOD-123FL

Surface Mount Schottky Rectifier

Maximum Ratings & Characteristics

Ratings at 25°C ambient temperature unless otherwise specified,

Parameter	Symbol	FS12	FS13	FS14	FS16	FS1B	FS1B5H	FS1CH	Unit	
Maximum repetitive peak reverse voltage	VRRM	20	30	40	60	100	150	200	V	
Maximum RMS voltage	VRMS	14	21	28	42	70	105	140	V	
Maximum DC blocking voltage	VDC	20	30	40	60	100	150	200	V	
Maximum average forward rectified current	IF(AV)	1,0							A	
Peak forward surge current 8,3 ms single half sine- wave superimposed on rated load	IFSM	30,0							A	
Operating junction temperature range	TJ	- 55 to + 150					- 55 to + 175			°C
Storage temperature range	TSTG	- 55 to + 150							°C	

Parameter	Test Conditions	Symbol	FS12	FS13	FS14	FS16	FS1B	FS1B5H	FS1CH	Unit
Maximum instantaneous forward voltage	IF=0,5A, TA=25°C	VF	0,40	0,45	0,55	0,75	0,80			Volts
	IF=1 A, TA=25°C		0,50	0,70	0,81	0,90				
Maximum DC reverse current at rated DC blocking voltage	TA=25°C	IR	200	200	200	150	200			uA
	TA=125°C		10	30	20					mA
Typical thermal resistance <sup>1)</sup>	junction to ambient	RθJA	90				°C/W			
	junction to case	RθJC	60							
	junction to mount	RθJM	20							

Note:1), The thermal resistance from junction to ambient, case or mount, mounted on P.C.B with 5×5mm copper pads,2 OZ, FR4 PCB

SOD-123FL

Surface Mount Schottky Rectifier

Ratings and Characteristics Curves

TA = 25°C unless otherwise noted

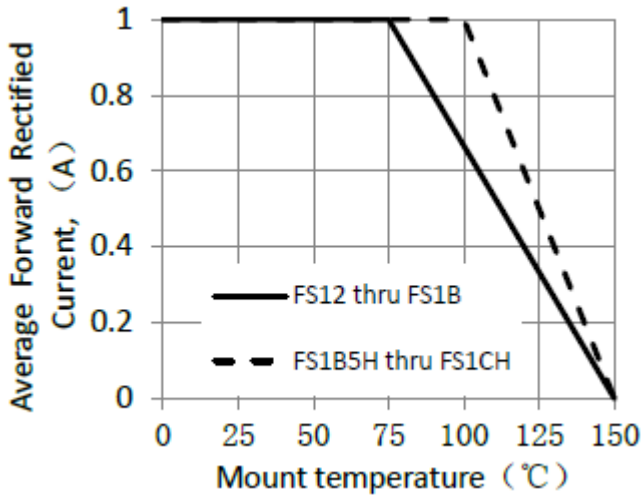

Forward Current Derating Curve

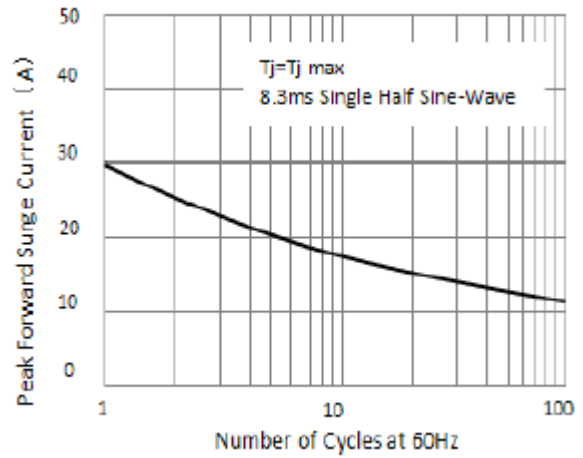

Maximum Non-Repetitive Peak Forward Surge Current

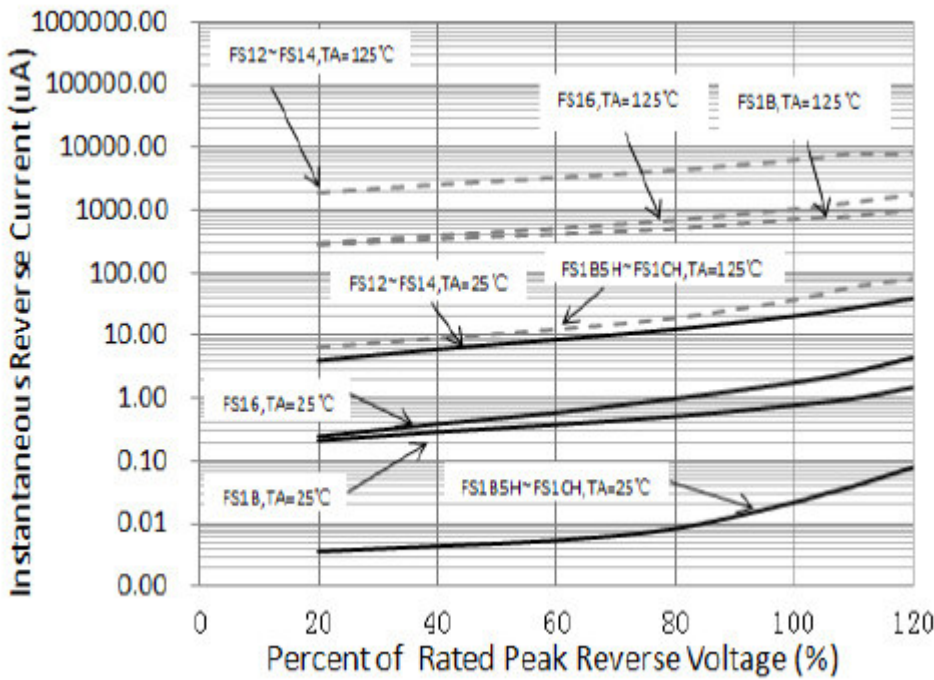

Typical Instantaneous Reverse Characteristics

SOD-123FL

Surface Mount Schottky Rectifier

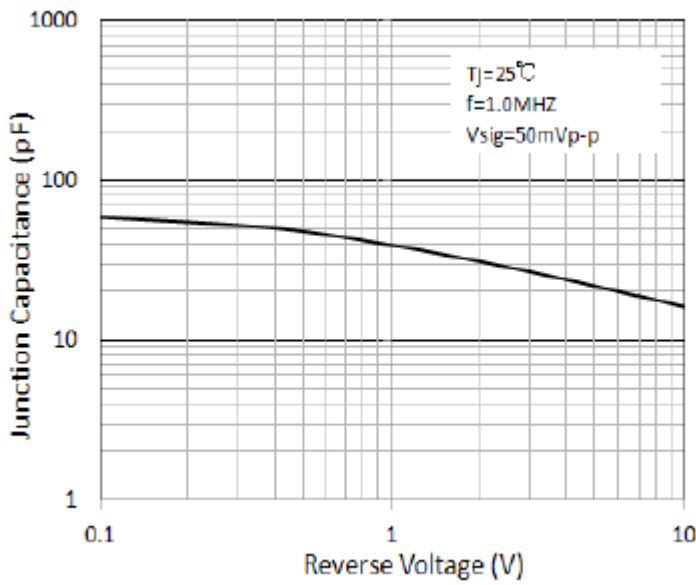

Typical Junction Capacitance

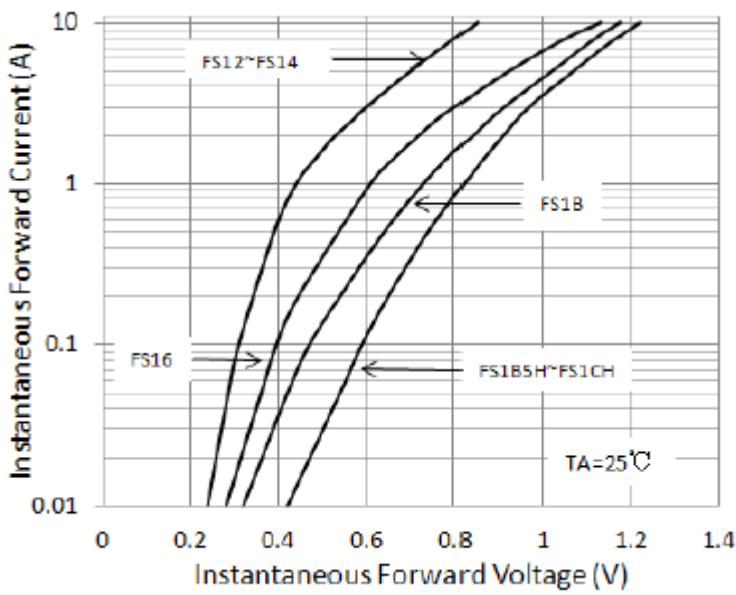

Typical Instantaneous Forward Characteristics

# SOD-123FL

# FrelTec Surface Mount Schottky Rectifier

## SPECIFICATION

### Tape & Reel Specification

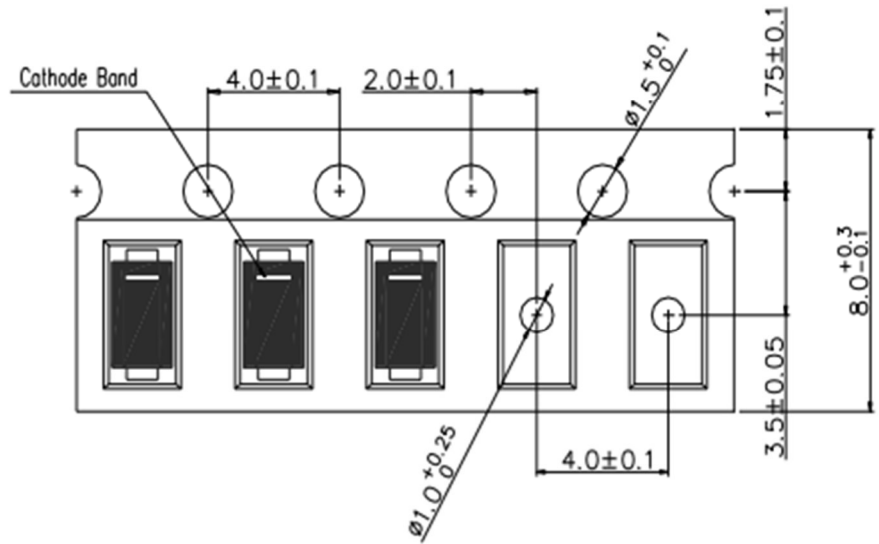

FrelTec

**Soldering Parameters**

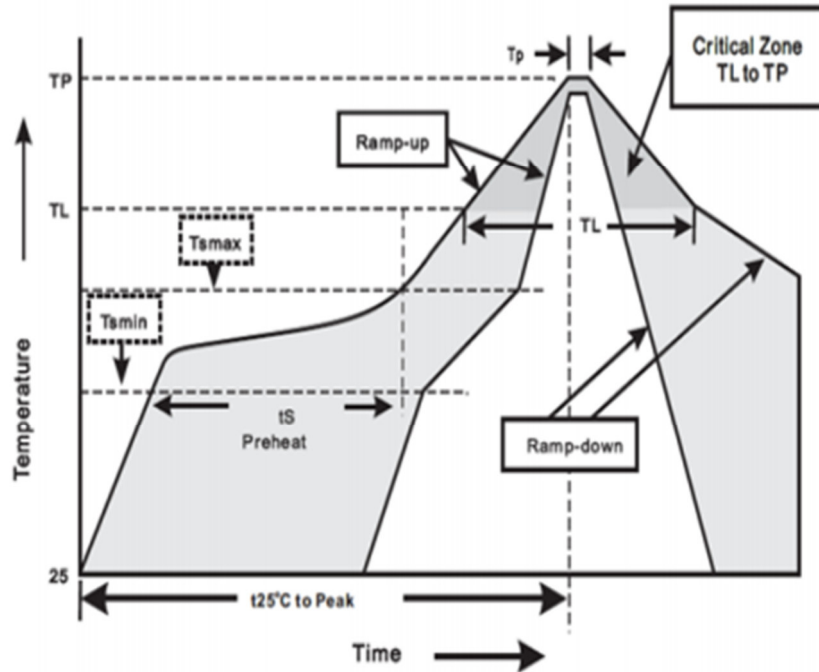

**Stock period**

The performance of these products, including the solderability, is guaranteed for 12 month, provided that they remain packed as they were when delivered and stored at a temperature of 20-30°C and a relative humidity 20-60%RH



## SOD-123FL

## Surface Mount Schottky Rectifier

Published by FrelTec® GmbH

Mathildenstr, 10A; 82319 Starnberg; Germany

© 2020 FrelTec® GmbH, All Rights Reserved,

The following applies to all products named in this publication:

1. The information describes the type of component and shall not be considered as assured characteristics,
2. Terms of delivery and rights to change design reserved,
3. Some parts of this publication contain statements about the suitability of our products for certain areas of application, These statements are based on our knowledge of typical requirements that are often placed on our products in the areas of application concerned, Nevertheless, we explicitly point out that such statements cannot be regarded as binding statements about the suitability of our products for a particular customer application, As a rule, FrelTec® is either unfamiliar with individual customer applications or less familiar with them than the customers themselves, For these reasons, it is always ultimately incumbent on the customer to check and decide whether a FrelTec® product with the properties described in the product specification is suitable for use in a particular customer application,
4. We also point out that in individual cases, a malfunction of electronic components or failure before the end of their usual service life cannot be completely ruled out in the current state of the art, even if they are operated as specified, In customer applications requiring a very high level of operational safety and especially in customer applications in which the malfunction or failure of an electronic component could endanger human life or health (e.g. in accident prevention or life-saving systems), it must therefore be ensured by means of suitable design of the customer application or other action taken by the customer (e.g. installation of protective circuitry or redundancy) that no injury or damage is sustained by third parties in the event of malfunction or failure of an electronic component,
5. The warnings, cautions and product-specific notes must be observed,
6. In order to satisfy certain technical requirements, some of the products described in this publication may contain substances subject to restrictions in certain jurisdictions (e.g. because they are classed as "hazardous"), Useful information on this will be found in our Material Data Sheets, Should you have any more detailed questions, please contact our sales offices,
7. We constantly strive to improve our products, Consequently, the products described in this publication may change from time to time, The same is true for the corresponding product specifications, Please check therefore to what extent product descriptions and specifications contained in this publication are still applicable before or when you place an order, We also reserve the right to discontinue production and delivery of products, Consequently, we cannot guarantee that all products named in this publication will always be available,
8. Unless otherwise agreed in individual contracts, all orders are subject to the current version of the "General conditions for the supply of products and services of the electrical and electronics industry" published by the German Electrical and Electronics Industry Association (ZVEI), available at [www.freltec.com](http://www.freltec.com),
9. As far as patents or other rights of third parties are concerned, liability is only assumed for components per se, not for applications, processes and circuits implemented within components or assemblies,
10. The trade name FrelTec® is a trademark registered or pending in Europe and in other countries,